



ABOVE GROUND AUTOMATIC SWIMMING POOL CLEANER

8STREME

**INSTRUCTION MANUAL
FOR MODELS
XT3, BLAZE, 5222, VTB300
XL300 TP2222**



ENGLISH

Page 33 of 34



8STREME

This Manual covers multiple models including 5222, XT3, VTB300, XL300, TP222, BLAZE

PRODUCT COLORS MAY VARY

Congratulations on the purchase of your new 8STREME Above Ground pool cleaner. It is a powerful autonomous robot delivered ready to use. This robot comes with an easy accessible debris basket along with floating rotary coupling which limits cable entanglement.

Please check the package to make sure that all parts are ready to be installed.

We recommend that you check the connections of the cables from the cleaner to the floating rotary coupling plug (chapter 4). If any parts are missing or damaged, please contact 8STREME directly on www.8streme.com

Table of contents

| | |
|------------------------------------------------|------|
| 01 Product features | p04. |
| 02 Warnings and Safety information | p04. |
| 03 Package contents | p05. |
| 04 Start-up | p06. |
| 05 Indicator Lights / LED | p09. |
| 06 Adjusting Direction and Speed Control | p10. |
| 07 Cleaning the basket | p11. |
| 08 Side suction | p12. |
| 09 Cleaning the impeller | p12. |
| 10 Troubleshooting | p13. |
| 11 Spare parts list | p16. |
| 12 Spare parts drawing | p16. |

01 Product features

Maximum Depth: 5 ft
Maximum size of the pool: 28ft
Input current: 100-130V AC
Output current: < 22VDC

02 !! Warnings and Safety informations !!

- | | | |
|--------------------------------------------------------------------------------------------------------------------------------------------------------------------------------------------------------------------------------------------------------------------------------------------------------------------------------------------------------------------------------------------------------------------------------------------------------------------------------------------------------------------------------------------------------------------------------------------------------------------------------------------------|-------------------------------------------------------------------------------------------------------------------------------------------------------------------------------------------------------------------------------------------------------------------------------------------------------------------------------------------------------------------------------------------------------------------------------------------------------------------------------------------------------------------------------------------------------------------------------------------------------------------------|--------------------------------------------------------------------------------------------------------------------------------------------------------------------------------------------------------------------------------------------------------------------------------------------------------------------------------------------------------------------------------------------------------------------------------------------------------------------------------------------------------------------------------------------------------------------------------------------------------------------------------------------------------------------------------------------------------------|
| <p>2.1 Please refer to the rules of your country regarding swimming pool safety.</p> <p>2.2 Place the power transformer at least 11 feet from pool edge.</p> <p>2.3 If the cables delivered are damaged, they must be replaced by the manufacturer, a service centre approved by the manufacturer or a qualified person to avoid any risk.</p> <p>2.4 Please make sure that your electrical system is well protected by a 30mA ground fault circuit interrupter (GFCI)</p> <p>2.5 Do not use extension cord.</p> <p>2.6 This unit must only be used with the supplied transformer.</p> <p>2.7 Keep the power transformer away from moisture.</p> | <p>2.8 This appliance can be used by adults aged from 18 years and above and persons with reduced physical, sensory or mental capabilities or lack of experience and knowledge if they have been given supervision or instruction concerning use of the appliance in a safe way and understand the hazards involved.</p> <p>2.9 Children shall not play with the appliance.</p> <p>2.10 Cleaning and user maintenance shall not be made by children without supervision.</p> <p>2.11 Do not use the robot out of the water.</p> <p>2.12 Do not use the robot if you have a counter-current swimming device working.</p> | <p>2.13 Make sure that the transformer is disconnected before performing maintenance on the robot.</p> <p>2.14 Don't use any damaged power cable or cord.</p> <p>2.15 Do not use the robot if people are in the pool.</p> <p>2.16 Do not use the swimming pool when the cleaner is in the pool.</p> <p>2.17 Remove the robotic cleaner from the swimming pool when not in use</p> <p>2.18 The use of the robot should be in a pool whose temperature is between 40 and 95°F.</p> <p>2.19 Make sure to maintain a pH close to 7.2 for optimal performance, especially on the ability to climb walls.</p> <p>2.20 If ambient air temperature exceeds 95°F, place power transformer out of direct sunlight.</p> |
|--------------------------------------------------------------------------------------------------------------------------------------------------------------------------------------------------------------------------------------------------------------------------------------------------------------------------------------------------------------------------------------------------------------------------------------------------------------------------------------------------------------------------------------------------------------------------------------------------------------------------------------------------|-------------------------------------------------------------------------------------------------------------------------------------------------------------------------------------------------------------------------------------------------------------------------------------------------------------------------------------------------------------------------------------------------------------------------------------------------------------------------------------------------------------------------------------------------------------------------------------------------------------------------|--------------------------------------------------------------------------------------------------------------------------------------------------------------------------------------------------------------------------------------------------------------------------------------------------------------------------------------------------------------------------------------------------------------------------------------------------------------------------------------------------------------------------------------------------------------------------------------------------------------------------------------------------------------------------------------------------------------|

03 Package contents

1. 5222 Robotic pool cleaner
2. Power transformer control box
3. Long cord
4. No-twist Floating device with rotary coupling
5. Sample of fine filter



QUICK FACTS



- Our robots are designed to facilitate the maintenance of your pool. However, they are not intended to clean a pool full of algae and leaves (ex: end of winter period).
In this case you must: use the leaf skimmer, clean the filter and put back on the filter and the pump.

-To remove the cleaner from your pool, lift the cable slowly and gently until you can grab it by the handle. Use the handle to fully pull out the cleaner

04 Start-up



4.1 Insert the end of the floating cable into the socket. Take note of the orientation of the plug and socket. Screw the nut of the floating cable firmly.



4.2 Insert the end of the floating cable from the transformer into the black "POWER" socket. Be careful with the direction of the plug.



4.3 Slide the cap to contact the plug of the floating swivel union.



4.4 Tighten the black nut on the floating rotary coupling by hand.



4.5 Repeat the operation on the blue side marked "POOL ROBOT" with the cable from the robot.

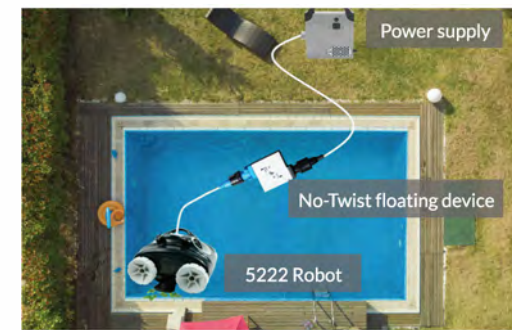

4.6 Place your power box to a midpoint between the two ends of your pool and at least 8 feet from the edge of the pool.



4.7 Place the robot in your pool and wait until it is completely submerged. If necessary, help it to sink manually.



4.8 Press the switch located at the top of the box to the ON position to activate your robot.

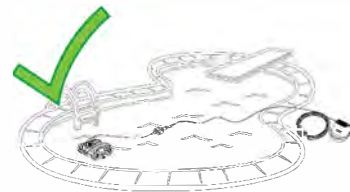

4.10 For optimal performance, place your robot in the pool at the furthest possible location from the power source.

This is the correct length of the cable so that the robot can reach all of your pool.

Limit the length of cable in the pool to the bare minimum for proper swivel operation. Tie up the excess cable near the power supply using the supplied reusable cable ties supplied with the cable.

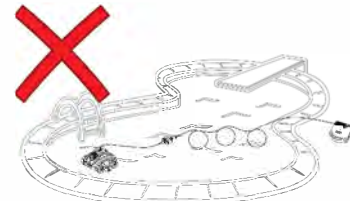

4.11 To turn off your robot, press the switch on the power supply to the OFF Position

4.12 Do not remove your robot out of water immediately after the end of its cleaning cycle so as not to cause a temperature shock.

4.13 When the cleaner is no longer used for an extended period, store your robot indoors.

05 Indicator lights / LED

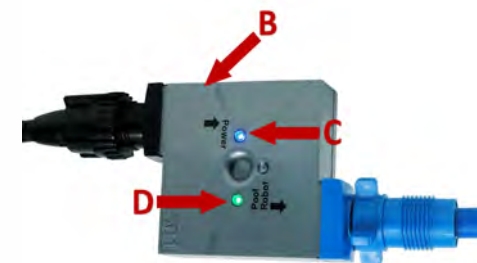
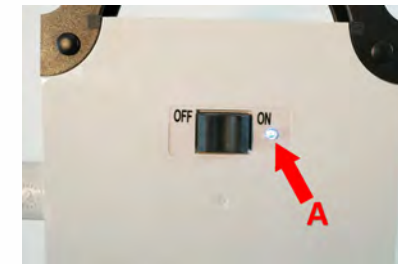

| INDICATOR LIGHT / LED | MEANING / DIAGNOSIS |
|-----------------------|---------------------------------------------------------------------------------------------------------------------------------------------------------------------------------------------------------------------------------------------------------------------------------------------------------------------------------------------------------------------------------------------|
| A | Plug the power supply into a protected AC voltage supply outlet. Switch the button to the ON position. The blue light will come on and stay solid blue. If it does not light, check the supply socket for power. If the blue light blinks, or does not come on the Power supply is defective and must be replaced. |
| B | "No-Twist" Floating Swivel |
| C | This blue light turns on when the floating cord between the transformer and the No-Twist float with swivel union is properly connected and you have turned on the robot. It indicates that power is reaching the float. If the light does not come on, check the connections . |
| D | This green light only lights up when the robot pump is running. This green light does not light up when the pool robot has completed its cleaning cycle or during certain phases of the device's operation (e. g. during a stop before a change of direction). |
| E | When the "No-Twist" float with rotating swivel is connected to the transformer and you have started the robot, this small red light indicates that the current is coming out of the float. You must have both this red light and the blue light (C) on the float. If you have the blue light on the float but not the red light, then it is likely that you will need to replace the float. |

06 Adjusting Direction and Speed Control



6.1 To adjust the direction of the robot, rotate the outlet cover. The direction of the robot will be determined by the position of the indicator.

Note: with indicator on vertical position, the robot will go straight ahead. With indicator turned right, the robot will go left. With indicator turned left, the cleaner will go right.

6.2 To adjust the speed of the robot, slide the red tab at the bottom of outlet cover. Sliding to the rabbit increase the speed and to the turtle decreases the speed.

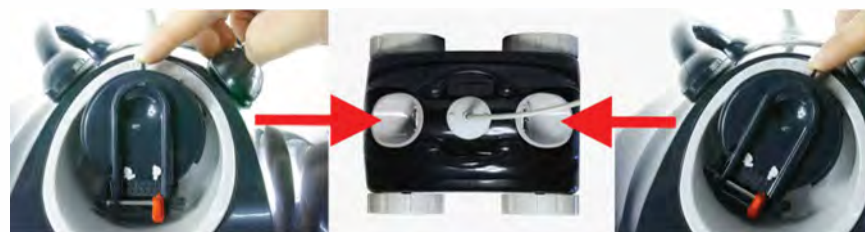

6.3 For most pools, it is recommended that the outlet cover at both ends do not share the same direction. For best performance have outlet at the hinge end of the cleaner be straight and then the outlet at the front of the cleaner rotated

NOTE:

These are recommended settings. Depending on the shape and size of your pool, you may have to play on direction and speed adjustments to reach the optimized setting for your pool.

07 Cleaning the filter basket



7.1 Press in the button at the front of the cleaner and lift up the top shell. Continue to lift up the shell until you hear a "click" at the hinge and the shell stays in place.

7.2 Lift up one end of the basket.

7.3 Pull back the red plastic tabs on one side and lift up the basket cover.

7.4 Dump out the debris inside the basket. Use a hose to spray water and clean the filter screen.

When cleaned, place your basket back into your robotic cleaner. If basket is not aligned properly it will not lock in place.

Press down on both ends of the basket. The basket should snap into place.



08 Side suction

NOTE :

A pair of side suction flap is provided to increase the vacuum path width up to 16 in.

Use this side suction flaps only if your pool has good flat bottom without pool liner pleats otherwise will slow down the pool cleaner robot significantly or even stop the cleaner robot from moving.

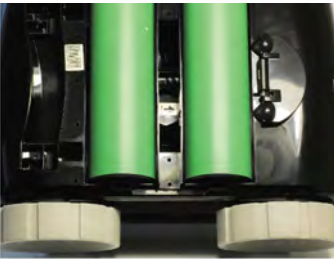

8.1: Flip the pool cleaner robot upside down



8.2: Place the flaps onto the pool cleaner robot as shown.

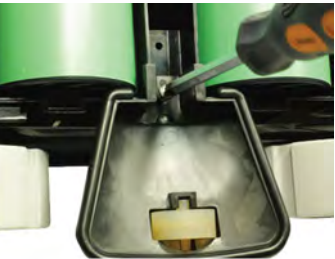

8.3: Then tight it up by the screw provided

09 Cleaning the impeller

NOTE :

Some debris can block or become wrapped around the impeller of the pump. By force, these debris can hinder the proper functioning of the robot or even damage the motor.

Regular visual inspection is part of the normal maintenance of the robot.



9.1: Remove the flap assembly to clean the dirt or hair on impeller



9.2: Use a flat screw driver to ply the flap assembly out as shown



9.3: Snap the flap assembly back after cleaning

10 Troubleshooting

| PROBLEM | CAUSE(S) | SOLUTION(S) |
|----------------------------------------------------------------------------------------------------------------------------|----------------------------------------------------------------------------------------------------------------------------------------------------------------------------------------------------------------------------------------------------------------------------------------------------------------------------------------------------------------|------------------------------------------------------------------------------------------------------------------------------------------------------------------------------------------------------------------------------------------------------------------------------------------------------------------------------------------------------------------------------------------------------------------------------------------------------------------------------------------------------------------------------------------------------------------------------------------------------------------------------------------------------------------------------------------------------------------------------------------|
| The robot floats on the surface. | <ul style="list-style-type: none">- Air is trapped inside the robot.- Use of fine filter insert. | <ul style="list-style-type: none">- When you put the robot in the pool, let it sink and reach the floor before you turn it on. If it does not sink, turn the robot upside down and shake to remove any air bubbles.- If you use an optional fine filter, remove the filter from its plastic wrap, immerse the filter in the water so that it is already wet before you put it in the robot and let the robot settle on the floor before you turn it on. Then turn the robot upside down in the pool and shake to remove any trapped air bubbles. |
| The robot does not clean all areas of the pool. | <ul style="list-style-type: none">- Not enough / too much cable floating in the pool- Improper directional settings and or speed settings | <ul style="list-style-type: none">- Make sure the length of floating cable introduced in the pool is just the required length.- Remove any excess cable length from the pool and leave this excess length outside the pool next to the power supply box.- Insert the robot at the center point of the pool. If your pool is oval or rectangular, this point is the middle of the length.- Check the setting of the cleaner directional system on page 10 section 6.1 to 6.3 |
| The robot does not recover debris during operation. Fine particles (dust or dirt, pollen ...) are ejected by the impeller. | <ul style="list-style-type: none">- The robot does not receive enough power- Basket clogged / full- An object is stuck in the impellers or the gills located in front of the impeller.- Debris are too fine, the robot is made to pick up the particles more than 50 microns (with the fine filter inside the basket) | <ul style="list-style-type: none">- Check the connection of the cables.- Clean the basket and filter panel. Clean the fine filter if you use this accessory.- Check if the basket is properly inserted. (See chapter Cleaning of the filter basket).- Check that there are no foreign objects in the impellers or blocked in the grid in front of the impellers- Check the attachment of the basket, press it if necessary to lock it.- Use a fine filter (check item number on the parts drawing 19, sku 51390 filters) on the other hand do not forget that it is the filtration of your swimming pool which ensures the cleaning of the particles of less than 50 microns. |

| PROBLEM | CAUSE(S) | SOLUTION(S) |
|----------------------------------------------------------------------------------------------------------|---------------------------------------------------------------------------------------------------------------------------|-------------------------------------------------------------------------------------------------------------------------------------------------------------------------------------------------------------------------------------------------------------------------------------------------------------|
| The robot moves in one direction | - An object blocks the rollers, the wheels of the robot or interfering with the movement of the robot. | - Unplug power supply and take robot out of water. Open the cleaner to inspect the cleaner. - Check that there are no foreign objects in the impellers. - Check that there are no foreign object blocking the rollers located below the cleaner. |
| The robot does not move and the filtration pump does not work either. The robot doesn't work any longer. | -The robot is not connected to a power source. -Power is off. | - Check that the power source is active by plugging another device into the power outlet. - Check that the power supply is turned on. - Check all connections of the robot to the power source. - Check that there are no foreign objects in the impellers. |
| The pump runs but the robot does not move. The robot turns on but stays on the spot. | - No / not enough power is transmitted to the robot - An object blocks the rollers., - Possibility of motor problem | - Unplug the power and take out the robot in the water. Open the cover of the basket and remove the basket. - Check that there are no foreign objects in the impellers. - Check that there are no foreign object blocking the rollers located below the cleaner. - Contact the After-sales Service |
| The robot stops after a few minutes | - Connection of the floating cable - Possibility of fault of the floating cable - Possibility of motor leakage | - Check the connection of the floating cable. Disconnect and reconnect as needed. - Check the status of the connectors at the ends of your cables (damaged, rusted, etc.) |
| The robot moves slower than before | - The robot is too heavy - The flow is not sufficient - Cables connections | - Check the basket and clean it if necessary. - Check that there are no foreign objects in the impellers. - Check that there are no foreign object blocking the rollers located below the cleaner. - Check the status of the connectors at the ends of your cables (damaged, rusted, etc.) |

| SYMPTOM | REASON(S) | SOLUTION(S) |
|---------------------------------------------------------------------------------------------------------------|------------------------------------------------------------------------------------------------------------------------------------------------------------------------------------------------------------------------------|----------------------------------------------------------------------------------------------------------------------------------------------------------------------------------------------------------------------------------------------------------------------------------------------------------------------------------------------------------------------------------------------------------------------------------------------------------------------------------|
| No LED lit on the transformer | - No power at electrical socket - Transformer (power supply) defective | - Check all connections (chapter 4). - If moisture is present on the plugs, let them dry before reconnecting them. - Check your electrical outlet - Replace transformer (power supply) - Contact customer service at 201 465 4200 ext 2 |
| The blue LED on the "No-Twist" floating swivel does not light up (light C of Chapter 5). | - Bad connection between the transformer and the No-Twist floating device. - Possibility of No-Twist floating swivel problem - You did not press the on/off switch located on the transformer to activate the cleaner. | - Turn ON the cleaner by pressing the ON / OFF switch located on top of the transformer. - Check all the connections of the cables between the transformer and the No-Twist floating device. - Contact the After-sales Service 201 465 4220 |
| The blue light on the "No-Twist" floating swivel is on but the red LED light does not (light E of Chapter 5). | - Electrical connection problem at the No-Twist swivel - Possibility of No-Twist floating swivel problem | - Check the status of the connectors at the ends of the No-Twist floating swivel (damaged, rusted, etc.) - Contact our Customer Service. 201 465 4220 ext 2 |
| The blue light on the No-Twist Floating device is on but the cleaner does not work (light C of Chapter 5). | - Bad connection between the No-Twist floating device and the cleaner - Possibility of No-Twist floating device problem - Possibility of motor problem. | - Check if the connection at the "No-twist" float outlet, blue outlet "Pool Cleaner" is correct and waterproof. - If the blue light C is on, you should also have a red light on at the float outlet (light E in Chapter 8). If this is not the case, it is likely that the swivel is defective. - If both blue and red lights are on but the robot does not work, please contact your dealer or our after-sales service at service@8streme.com or call 201 465 4220 ext 2 |

Please contact www.8streme.com if you have any other questions.

11 Spare parts list and drawing

| Item | Part No. | Part description |
|------|----------|------------------------------------------|
| 1 | 5133 | Curved handle set. L & R |
| 2 | 5124 | Pump outlet flap assembly |
| 3 | 5120 | Pump motor |
| 4 | 5130 | Top shell |
| 5 | 5135 | Latch lock |
| 6 | 5131 | Bottom chassis |
| 7 | 5115 | Side wheels, 4pcs as a set |
| 8 | 5134 | Quick drain flap |
| 9 | 5105 | Roller tubes, 2pcs as a set |
| 10 | 5149 | Sweeper brush |
| 11 | 5141 | Side suction flap, 2pcs set |
| 12 | 5100 | Debris basket |
| 13 | 8100 | Door hinge set |
| 14 | 3015 | Power supply. 60W-22V |
| 15 | 3313 | Floating cord with swivel. 10m long Grey |
| 16 | 3311 | Robot end floating cord. Grey |
| 17 | 3501 | Self-diagnostics square swivel |
| 18 | 5100 | Filter screen |
| 19 | 5139 | (Optional) Fine filtration kit |

