

PARTS LISTING

BRISTOL OVAL

PBRI-YS****52SSPSSN1

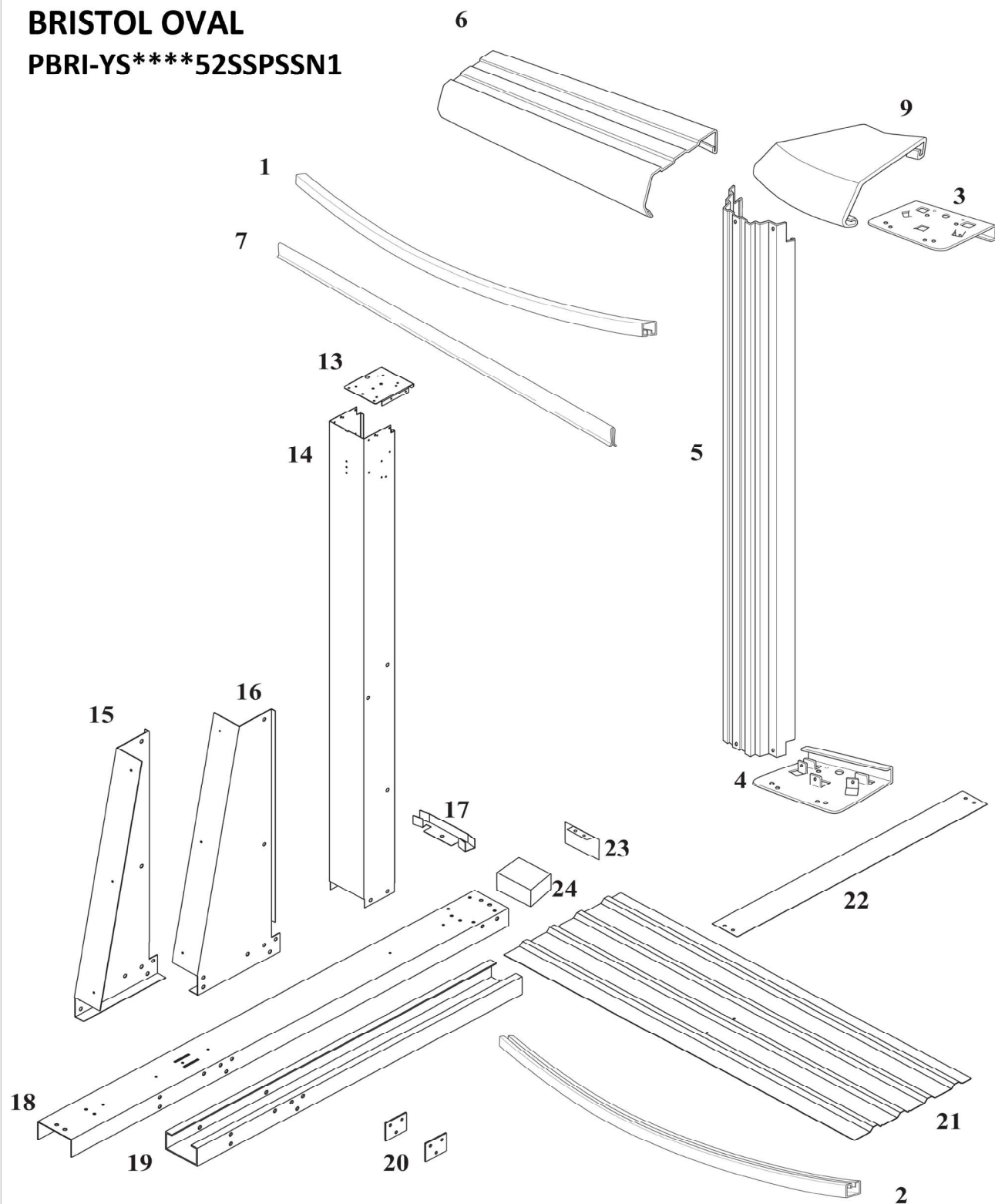

IMPORTANT NOTE:

Make sure you have all the parts necessary before you start installation.

PARTS LISTING

Product Description:			Bristol Yardmore Oval					
Product Code:			PBRI-YS****52SSPSSN1					
Qty Required for Installation (by Size)								
Index #	Description	Part #	Length	812	1016	1019	1218	1220
6	Top Rail Curved	21424	40-1/8"		6	6	8	10
6	Top Rail Curved	21423	27-1/4"	10				
6	Top Rail Transition	41242	30"	4				
6	Top Rail Transition	41243	45-5/8"		4	4		
6	Top Rail Transition	35372	47-1/4"				4	
6	Top Rail Straight Side	21427	41-1/4"		2	4	2	6
5	Upright	21430	51-13/16"	12	8	8	10	12
14	W-A Upright Oval Straight Side	35738	52"	2	4	6	4	4
9	Top Cap	41106	6"	14	12	14	14	16
13	Top Plate Oval	10136	4"	2	4	6	4	4
3 & 4	Top / Bottom Plate	11595	4-1/2"	24	16	16	20	24
7	Plastic Coping	10296	48"	9	12	13	13	15
1	Inner Stabilizer	38500	29-1/2"	10				
1	Inner Stabilizer	38501	42-5/8"		6	6	8	10
1	Straight Middle Stabilizer	38512	33"		2	4	2	2
1	Straight Center Stabilizer	38513	8"	2	4	6	4	4
1	Rim	38514	43"				4	
1	Inner Stabilizer Transition	38515	29 1/2"	4				
1	Inner Stabilizer Transition	38516	41-3/8"		4	4		
1	Rim	22909	39"					4
2	Bottom Rail	18837	25-1/4"	10				
2	Bottom Rail	38736	38"		6	6	8	10
2	Bottom Rail Transition	37391	27-1/4"	4				
2	Bottom Rail Straight Side	16713	37.5"		2	4	2	2
17	Connector Bottom Rail Straight Side	16542	1"	2	4	6	4	4
2	Bottom Rail Corner	16714	39"					4
2	Bottom Rail Corner	38035	42-5/8"		4	4		
2	Bottom Rail Corner	22901	45"				4	
21	Pressure Plate	16549	44"	4	8	12	8	8
23	Oval Channel End Cap	22726		2	4	6	4	4
24	Oval Channel Foam Block	29917	2x4x4-1/8"	2	4	6	4	4
19	Under Ground Channel YM	27646	35 9/16"	2	4	6	4	4
15	Yardmore Gusset Left	35740		2	4	6	4	4
16	Yardmore Gusset Right	35741		2	4	6	4	4
22	Strap Section	27645	43 1/2"	2	4	6	4	4
22	Strap Section	16724	41 11/16"				4	4
22	Strap Section	33095	28-5/8"		4	6		
22	Strap Section	33160	32-1/4"	1				
*	Wall Bars (2 Pack)	40335	52"	1	1	1	1	1
*	Hardware Stainless Steel Base Pack YM (4 Uprights)	22-16720			1	1	1	1
*	Hardware Stainless Steel Base Pack YM (2 Uprights)	22-16722		1		1		
*	Hardware	44-10033		1			1	
*	Hardware	44-10034						1
*	Hardware	44-10035			1			
*	Hardware	44-10036				1		
*	Hardware	44-10212		1	1	1	1	1
*	Instruction Addendum for SS Oval System	95-0701		1	1	1	1	1
*	Envelope Safety Stickers	95-0007		1	1	1	1	1

*May not be pictured